

DRAINAGE THRU SIDEWALK

SCALE: N.T.S.

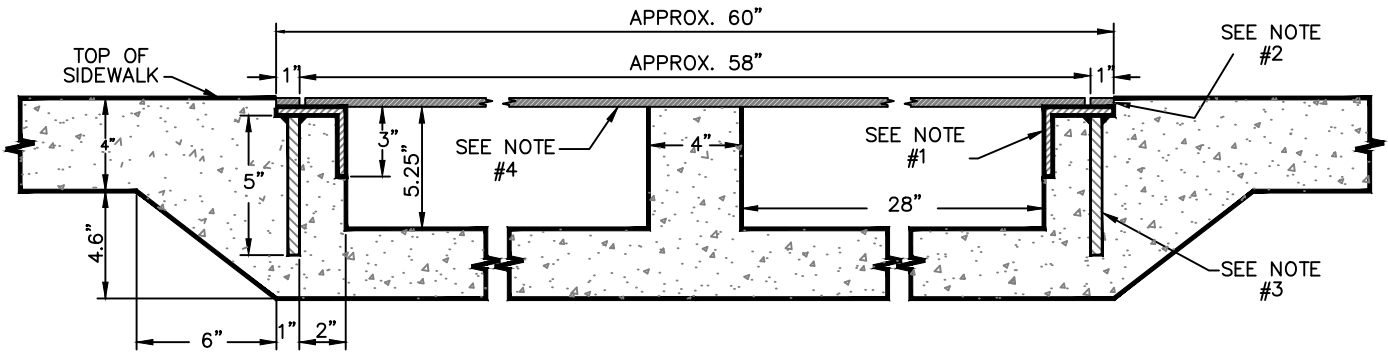

- NOTES:
1. 3" X 3" X 3/8" ANGLE IRON- 4" LENGTH.
 2. 1" X 3/8" X 4" RECTANGULAR PLATE TO BE TACK WELDED TO ANGLE IRON
 3. 1/2" DIA. X 6" LENGTH RODS PLACED 6" FROM EACH END OF ANGLE IRON
 4. 57.3" X 3/8" X 4" LENGTH TREAD PLATE (RAISED PATTERN) TO BE TACK WELDED TO ANGLE IRON